

REVISION BLOCK	
REV	REVISION DESCRIPTION
NONE	DRAWING RELEASE: 31 DEC 18

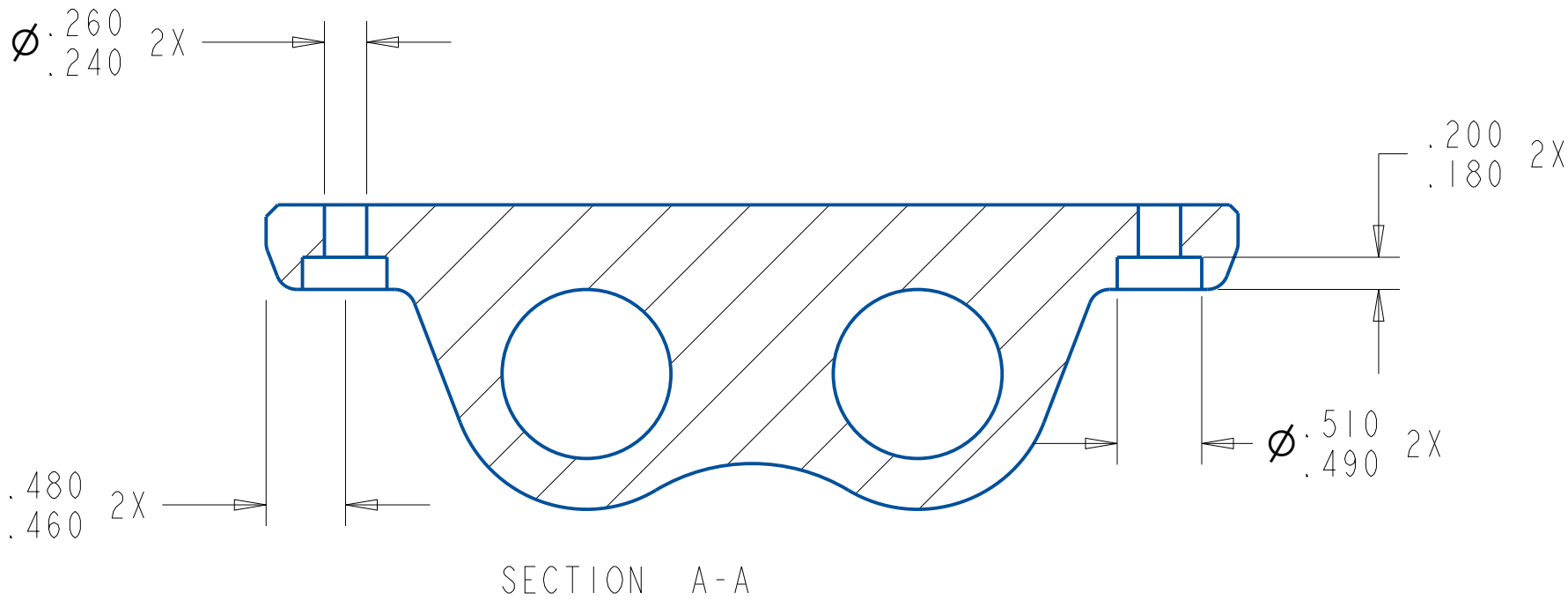
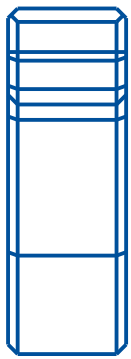
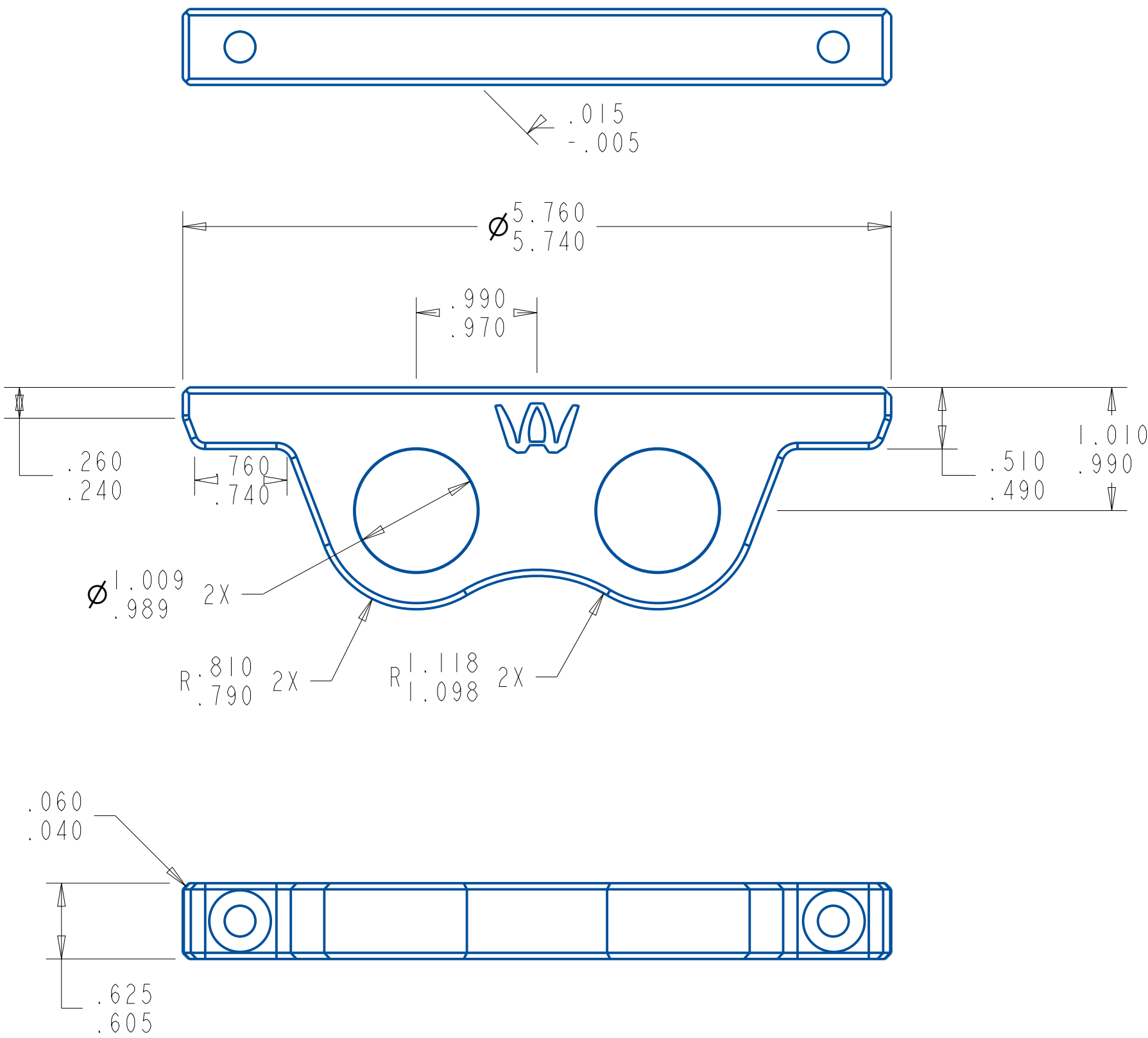

NOTES:

DRAWING REFERENCES ASME Y14.5M-1994 STANDARD
DO NOT SCALE DRAWING

REQUIREMENTS FOR FINISHED PART UNLESS OTHERWISE SPECIFIED.
ALL DIMENSIONS APPLY AFTER COATING.

DIMENSIONS SHOWN ARE IN INCHES UNLESS OTHERWISE SPECIFIED.

TOLERANCES: DECIMAL: $\pm .010$ ANGULAR: $\pm 1^\circ$
CORNER BREAK (EXTERNAL & INTERNAL) ---- .020 / .002 RADIUS OR EQUIVALENT
THREAD CHAMFER (OR COUNTERSINK) ----- 1 TO 1 1/2 THREADS DEEP

GENERAL FINISH ----- 250 (MAX)

ANY INFORMATION, DATA AND DRAWINGS SHOWN ON THIS DOCUMENT IS CONFIDENTIAL.
IT IS SUPPLIED WITH THE UNDERSTANDING THAT IT BE RETURNED ON REQUEST. THIS
DOCUMENT WILL NOT BE DISCLOSED, COPIED, REPRODUCED TO ANY THIRD PARTY
WITHOUT THE PRIOR WRITTEN CONSENT OF GREEN LADDER TECHNOLOGIES, LLC

SHEET		PROJECT	NEXT ASSEMBLY	
I OF I		TORMACH	LBL094	
LAST BASTION LABS				
6038 CLOVERMEADOWS AVE SCOTTS, MI 49088				
TITLE				
TIGHTEN LOSESSEN BASE				
DESIGNED BY: T. AUSTIN		MATERIAL 6061 T6 AL		
APPROVED BY: T. AUSTIN		FINISH RED POWDER COAT		
DRAWING NO. LBL095			SIZE B	REV NONE